

REVISIONS			
REV.	DESCRIPTION	DATE	APPROVED
G	As Released	7/15/1998	SECO

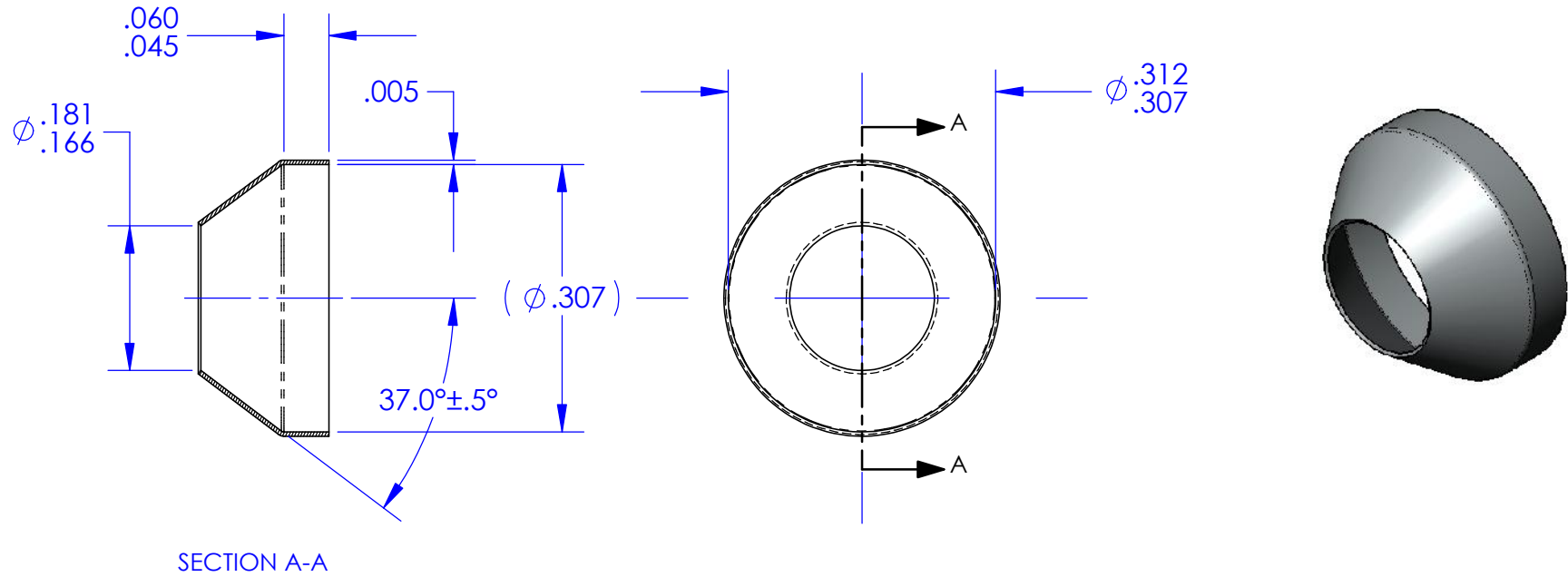

NOTES: UNLESS OTHERWISE SPECIFIED

1. MATERIAL: ALUMINUM ALLOY 1100 SHEET, CONDITION "0" PER QQ-A-250/1, QQ-A-1876 OR AMS 4001.
2. FINISH: TINPLATED PER MIL-T-10727, TYPE 1 OR AMS 2408-2.
3. THESE PARTS ARE ANNEALED. DIMENSIONS "A" AND "C" SHALL BEVERIFIED BY INSTALLING THE SEAL ON A STANDARD FITTING PER MS3351 4 OF APPROPRIATE SIZE. AN OUT-OF ROUND CONDITION WHICH DOES NOT PREVENT SUCH INSTALLATION SHALL NOT BE A CAUSE FOR REJECTION UNLESS THE SEAL MATERIAL IS CREATED OR NICKED.
4. BREAK ALL SHARP EDGES AND REMOVE ALL BURRS.

ECCN 9A991.d		DRAWING SIZE		SECO SEALS, INC. sales@secoseals.com		1370 LOGAN AVE. UNIT K COSTA MESA, CA. 92626		(714) 546-3478 www.secoseals.com	
MATL:	See Note 1	FSCM:			FILE NAME:		SECO7AT3		REV. G
TREATMENT:		INCHES DIMENSIONS IN INCHES 3RD ANGLE PROJECTION 			DESC.:				STANDARD:
Annealed after Forming				Conical Seal for 3/16" Flared Tube Fitting, 37 Degree.				SECO 7	
MATL SIZE:				TITLE:		DRAWN BY:		CAGE CODE:	
.005 Thk. Sheet				SECO 7 Seal		Joe Littel		33447	
				DATE DRAWN:		SCALE:		CHECKED BY:	
				4/10/2015		5:1		Jim Scott	
								SHEET 1 of 1	